

ZÁBRADLÍ Z1
M 1:20
POHLED 1

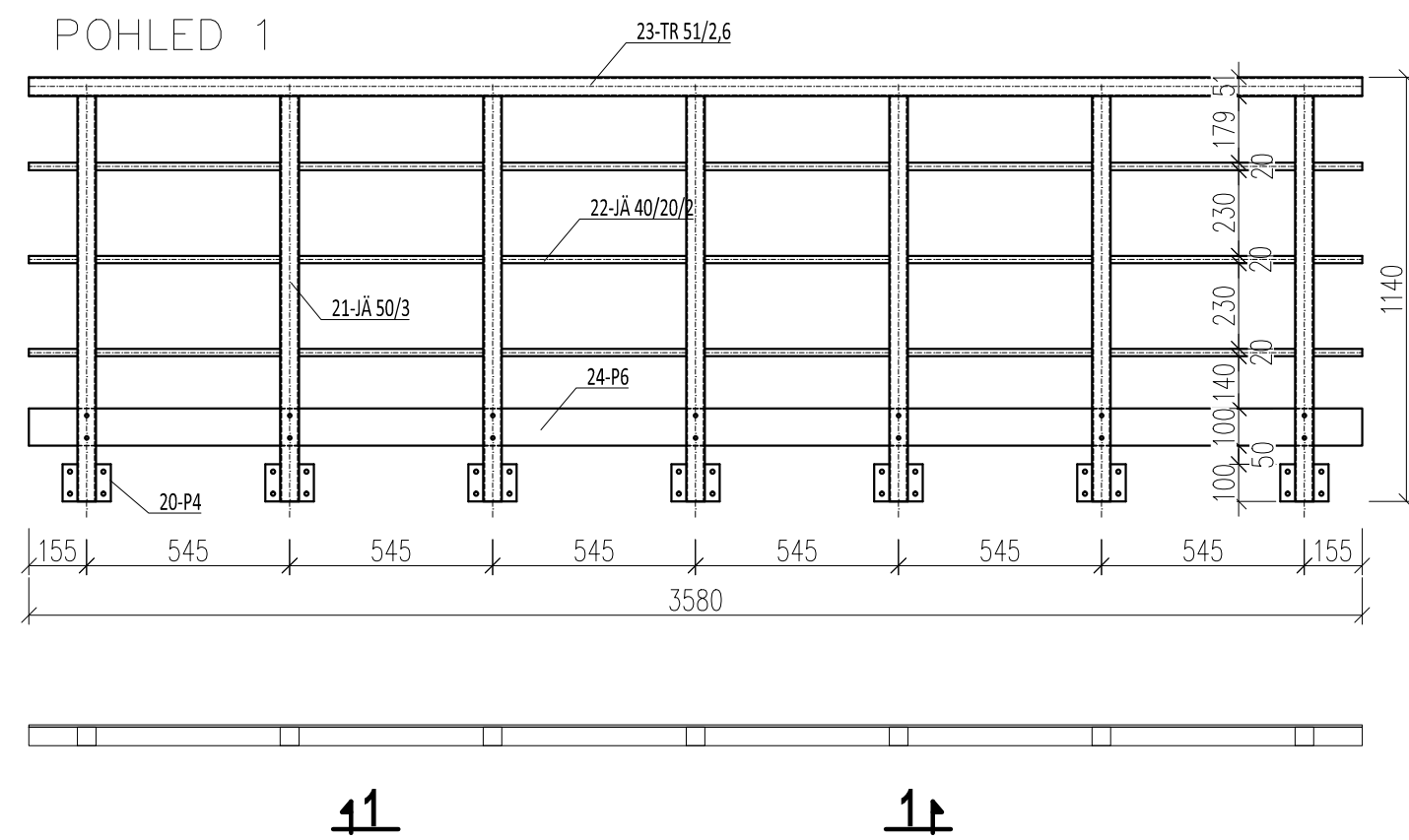

ZÁBRADLÍ Z4
M 1:20
POHLED 1

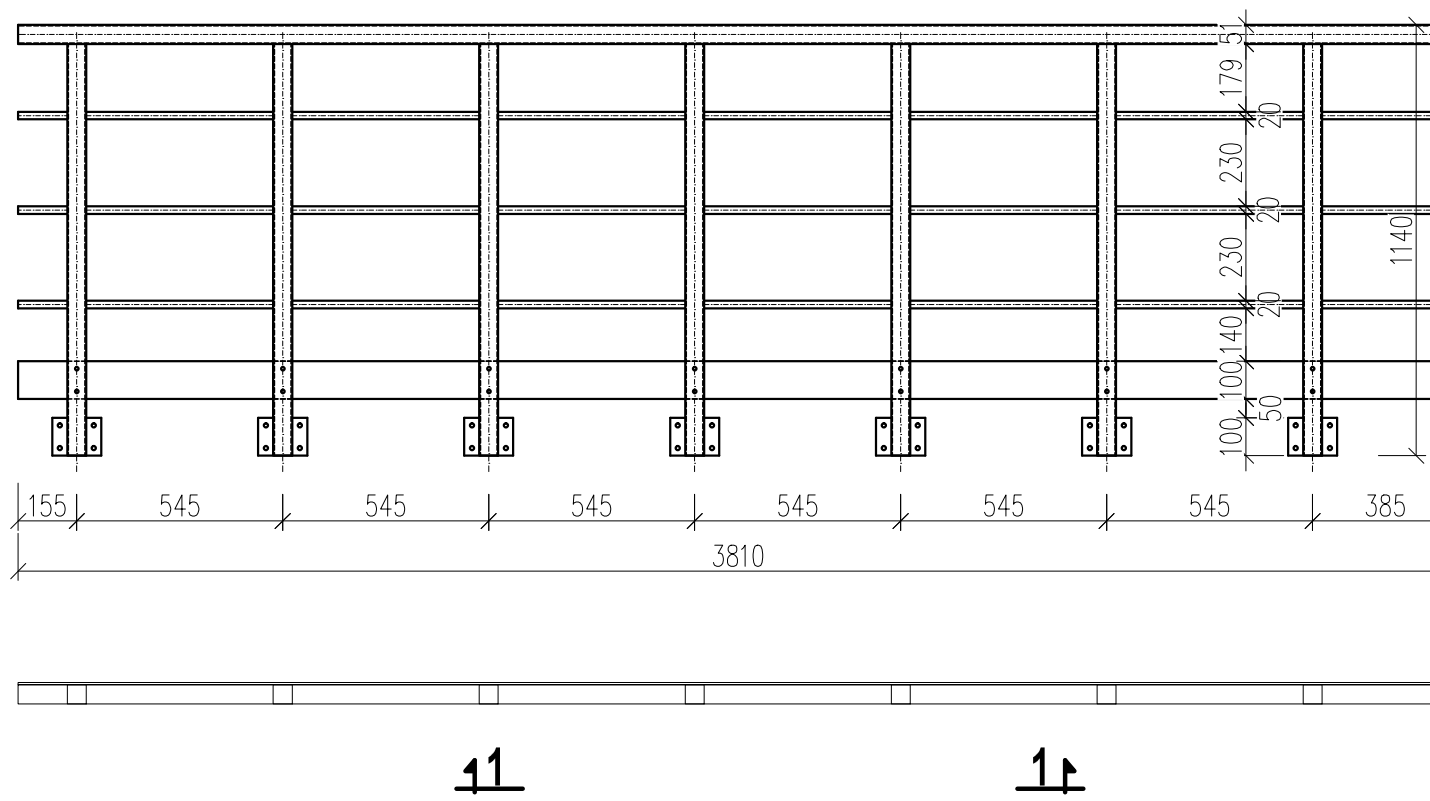

ZÁBRADLÍ Z9
M 1:20
POHLED 1

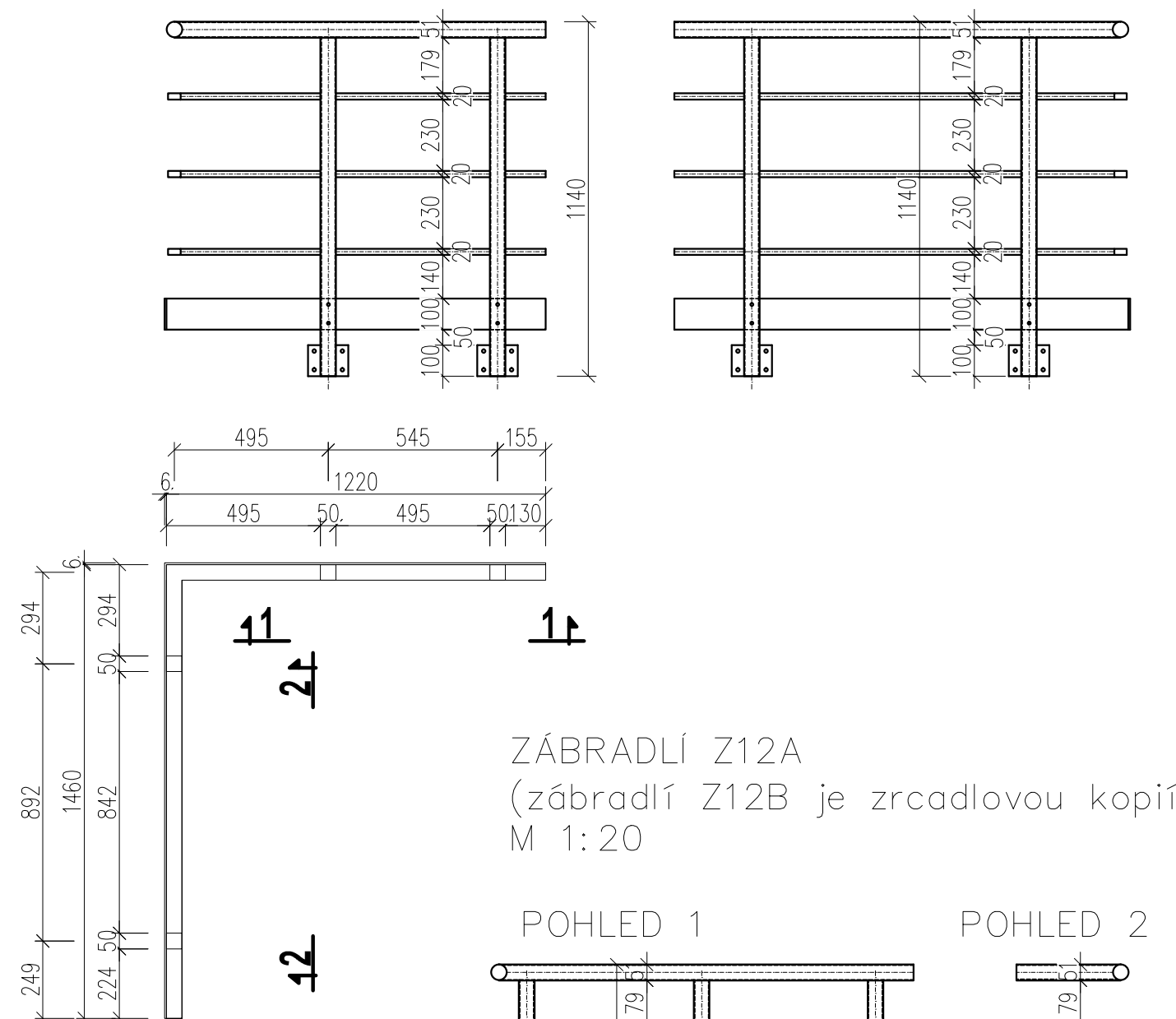

ZÁBRADLI Z12A
(zábradlí Z12B je zrcadlovou kopií)
M 1:20

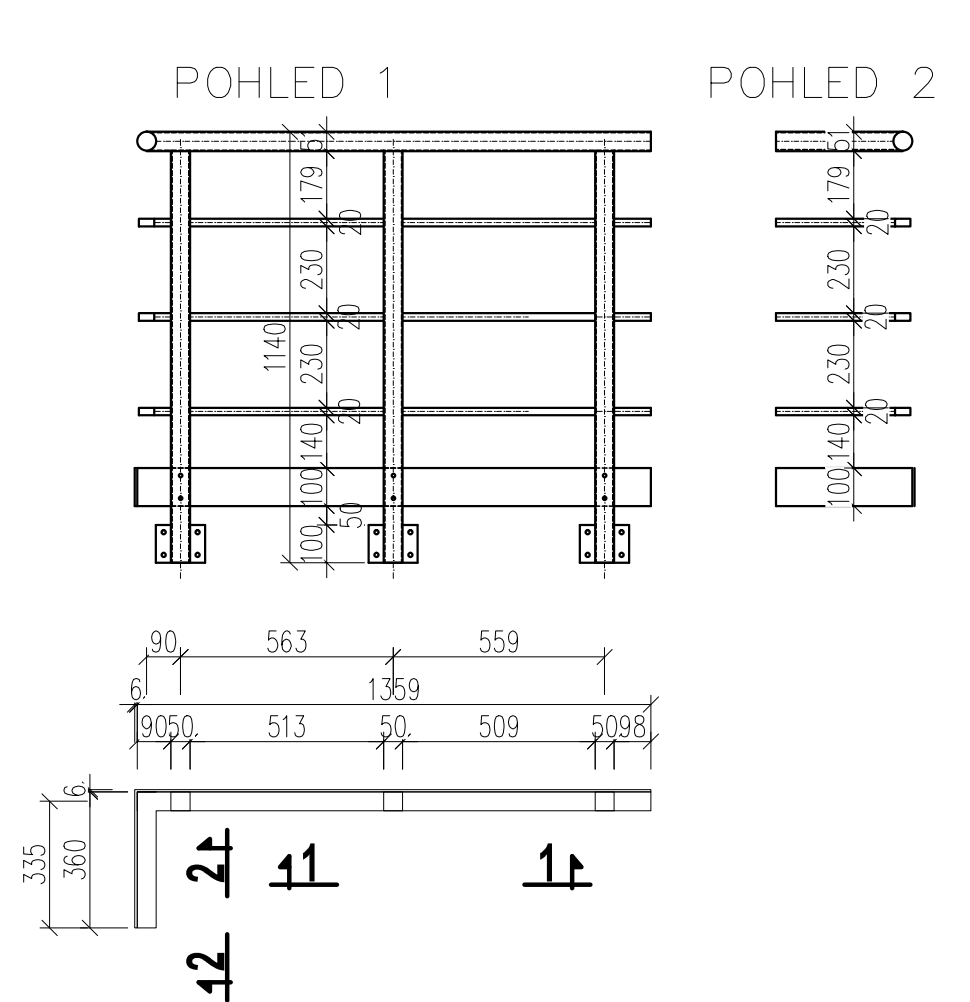

ZÁBRADLÍ Z2
M 1:20
POHLED 1

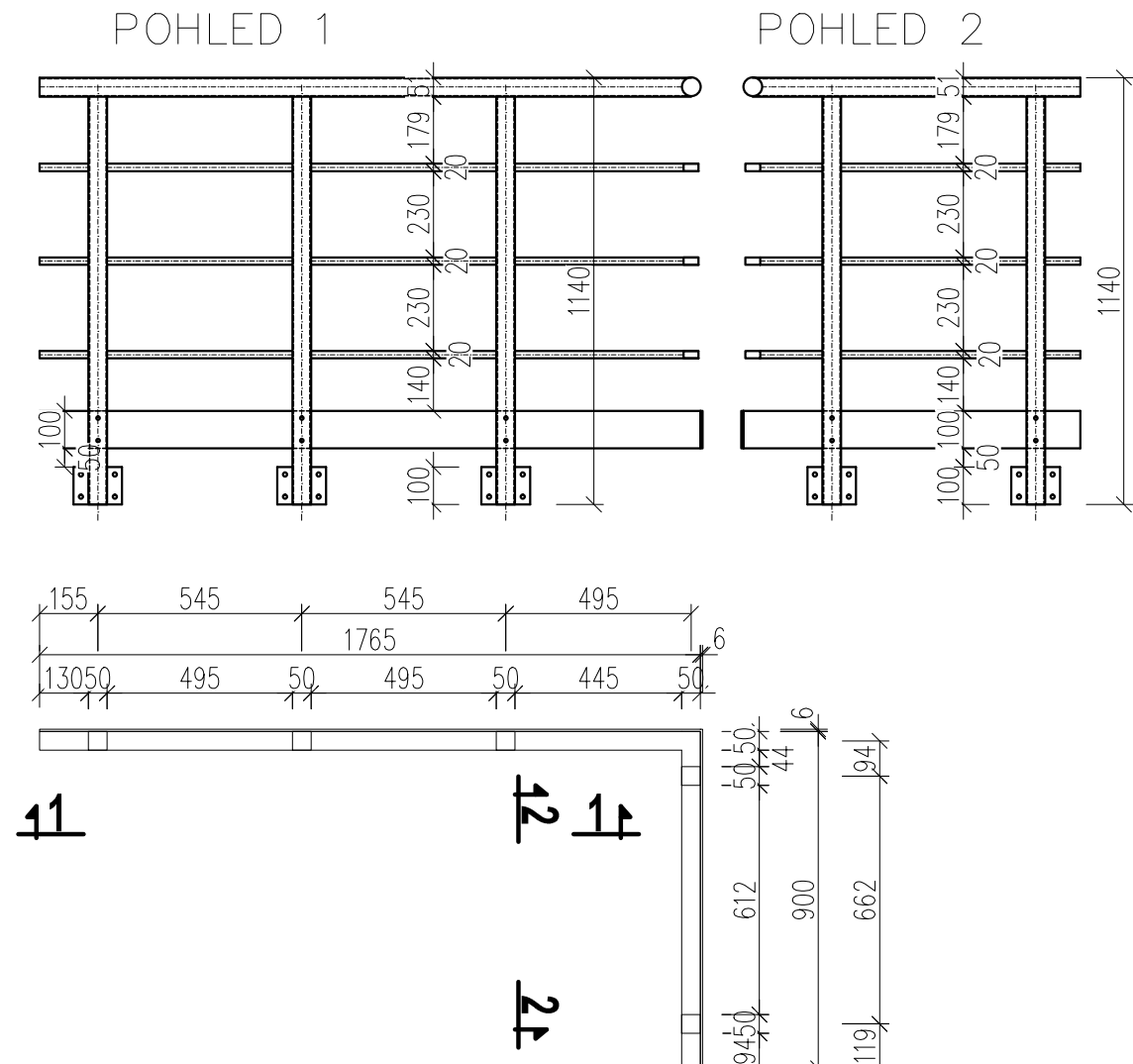

ZÁBRADLÍ Z5A
M 1:20
(zábradlí Z5B je zrcadlovou kopií)
POHLED 1

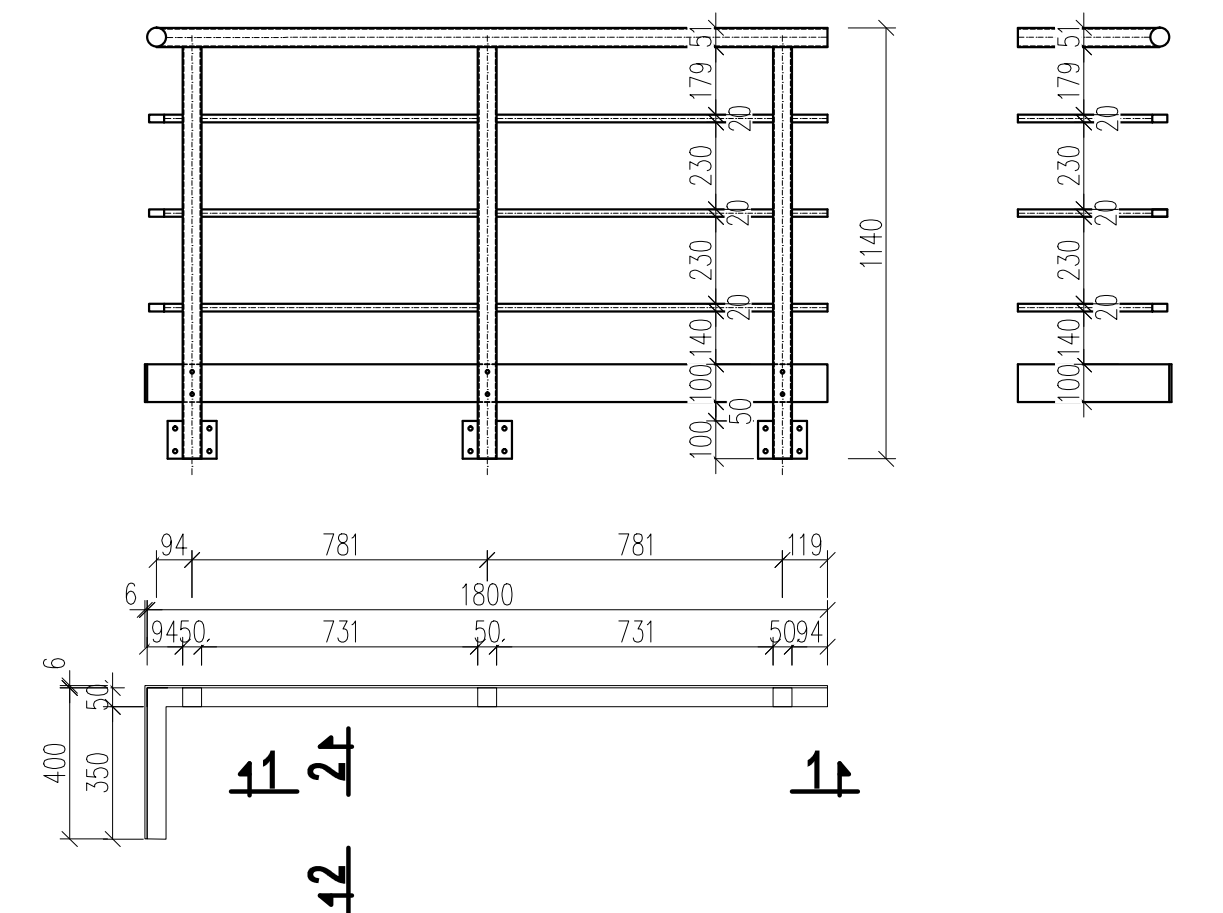

ZÁBRADLÍ Z11
M 1:20

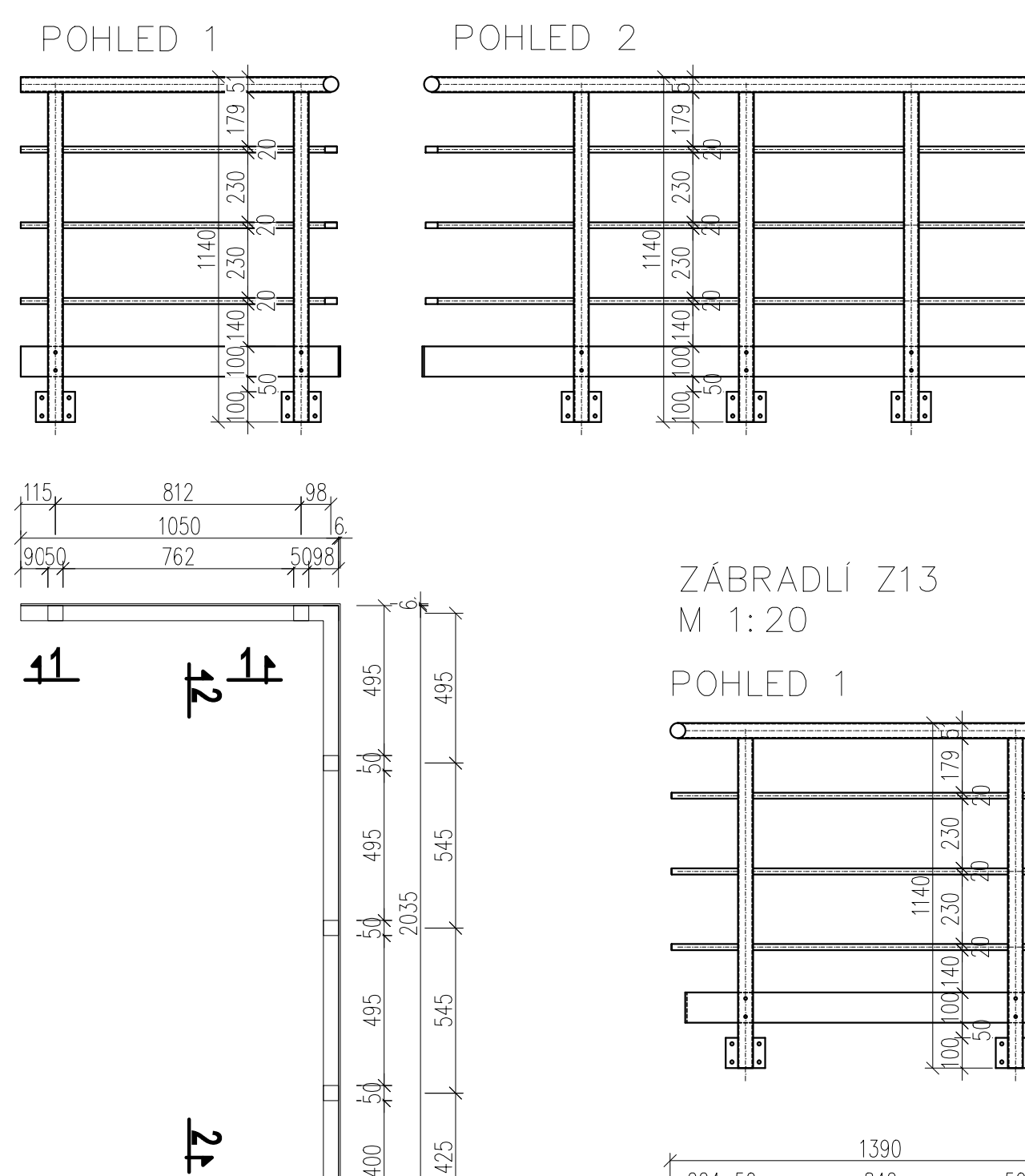

ZÁBRADLÍ Z3
M 1:20
POHLED 1

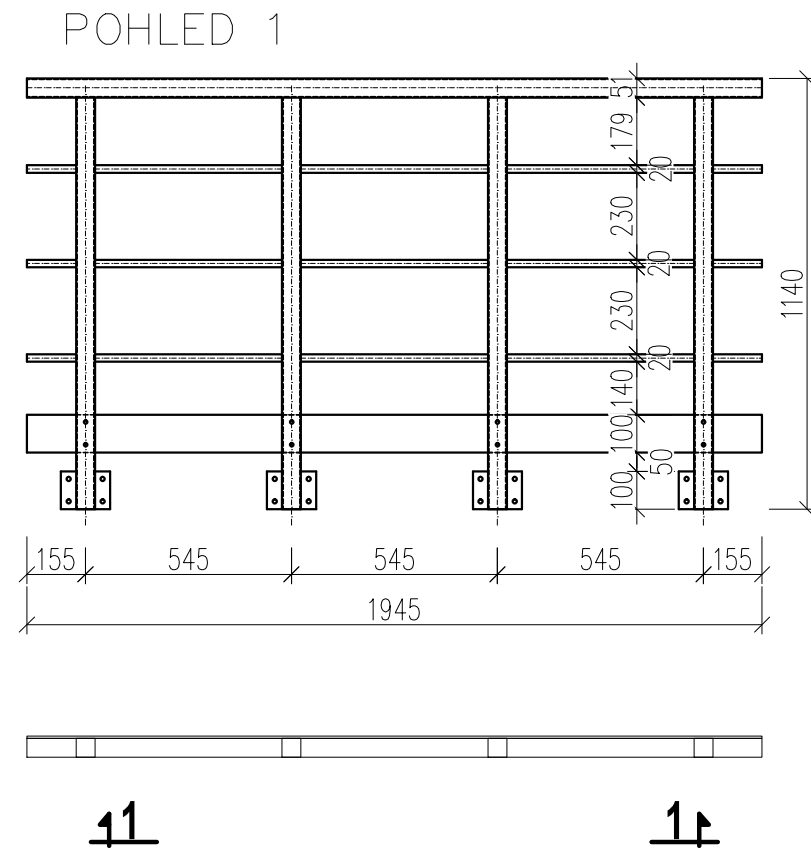

ZÁBRADLÍ Z8
M 1:20
POHLED 1

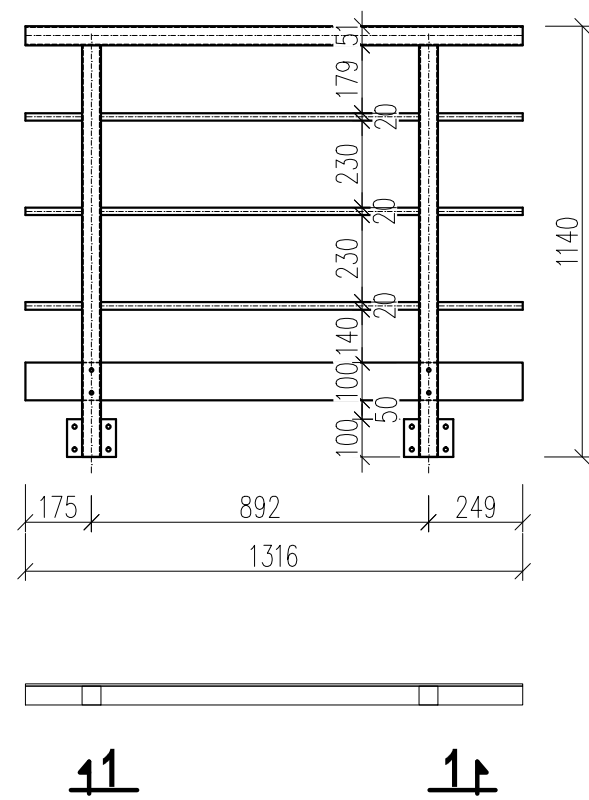

ZÁBRADLÍ Z14
M 1:20
POHLED 1

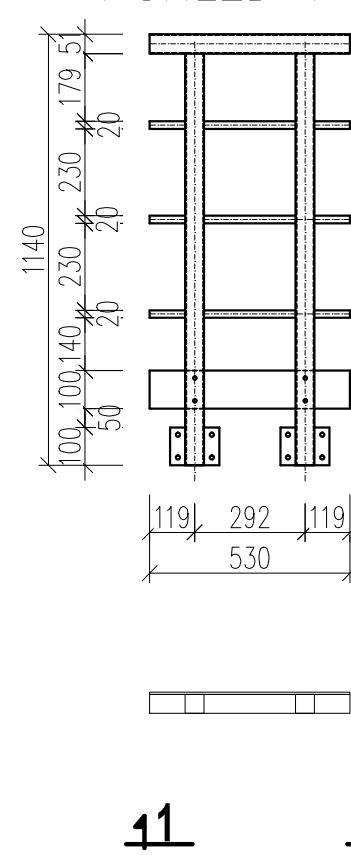

ZÁBRADLÍ Z15
M 1:20
POHLED 1

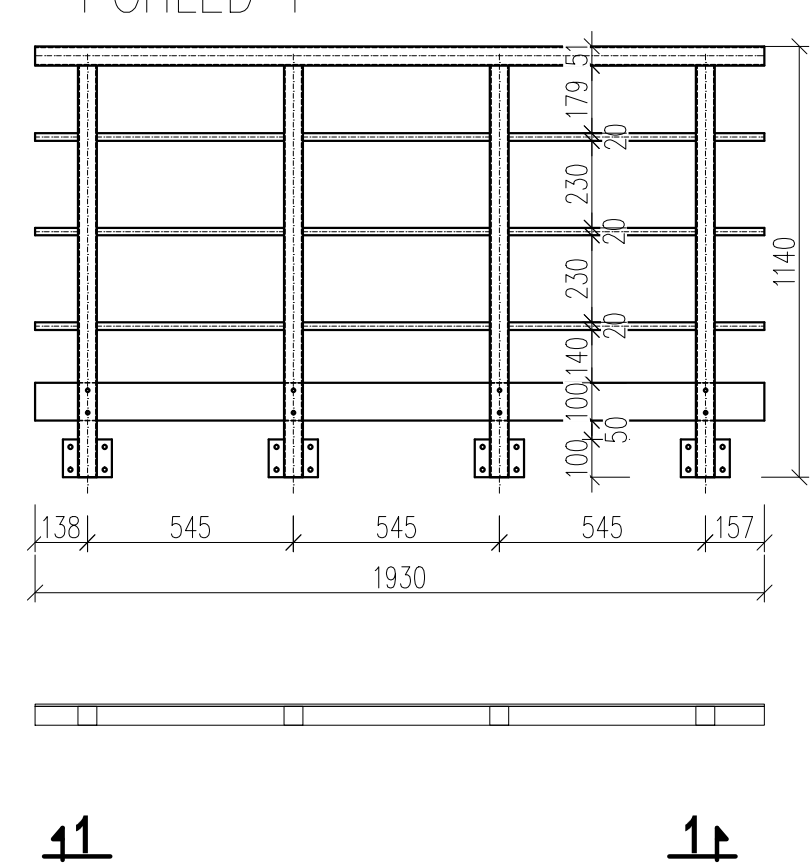

ZÁBRADLÍ Z7
M 1:20
POHLED 1

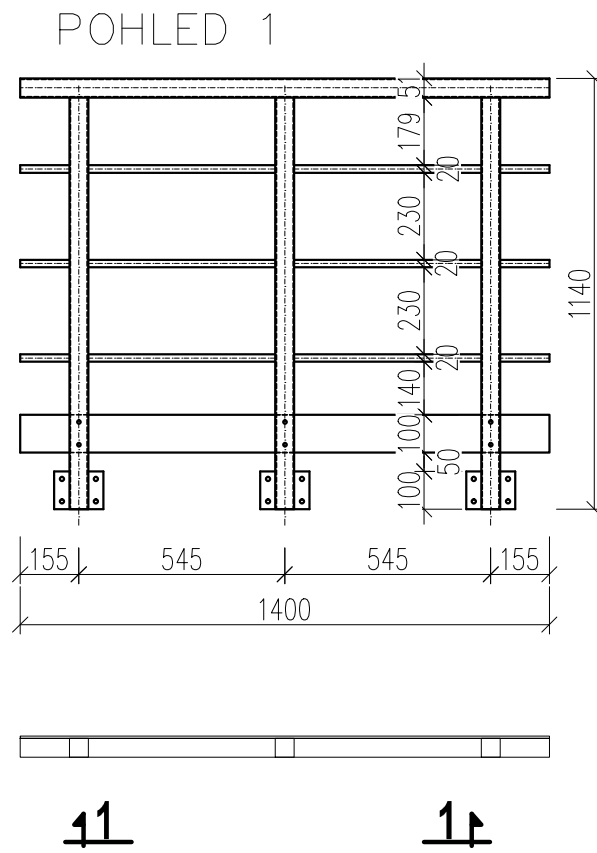

ZÁBRADLÍ Z10
M 1:20
POHLED 1

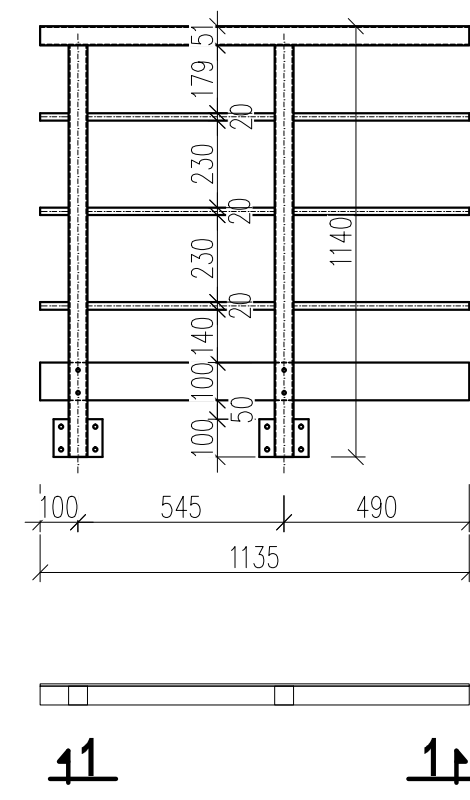

ZÁBRADLÍ Z6
M 1:20
POHLED 1

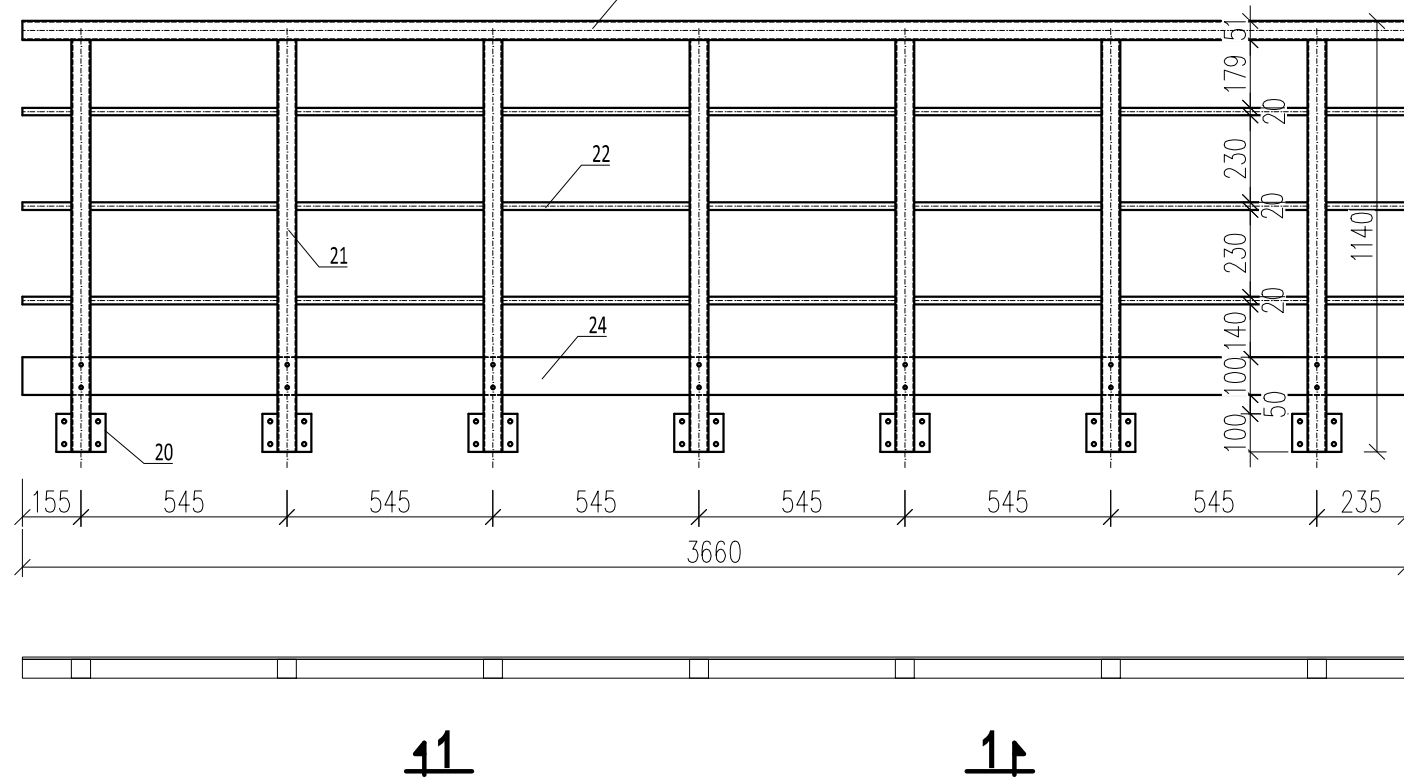

ZÁBRADLÍ Z16
M 1:20
POHLED 1

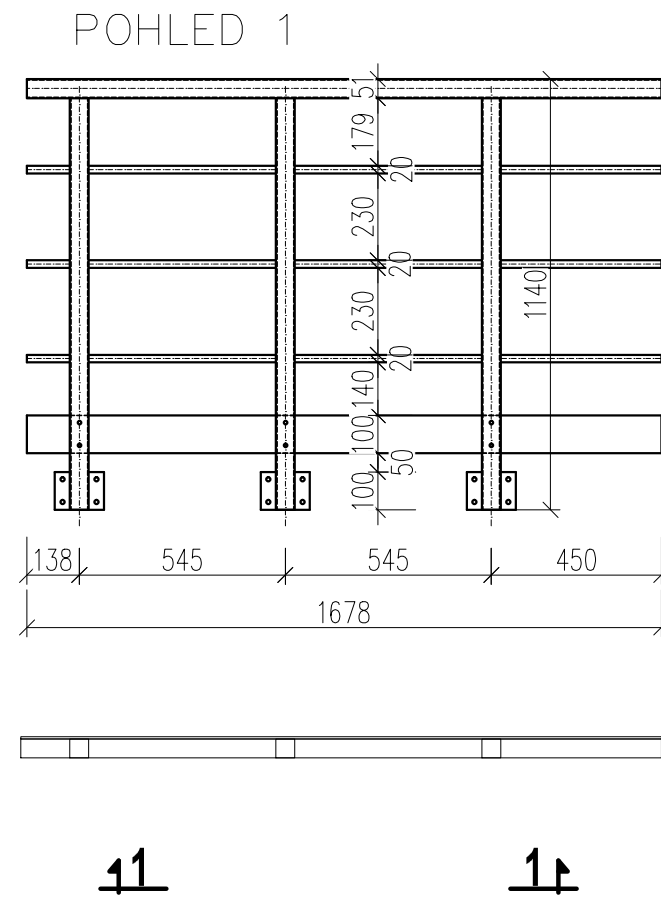

ZÁBRADLÍ Z17
M 1:20
POHLED 1

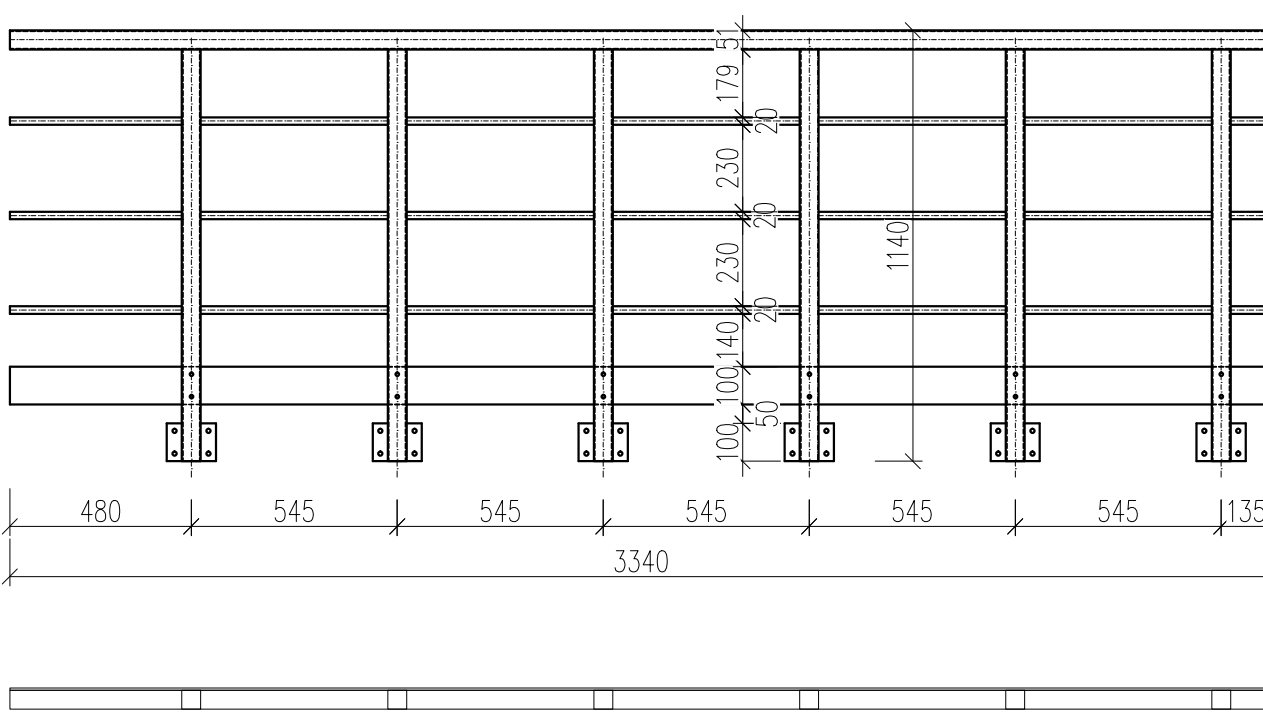

KOTVENÍ ZÁBRADLÍ
M 1:10

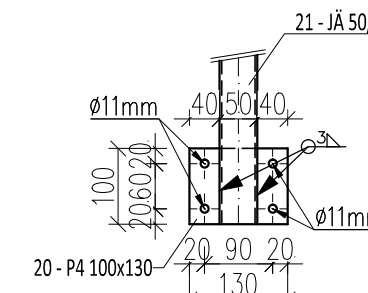

KOTVENÍ OKOP. PLECHU
M 1:10

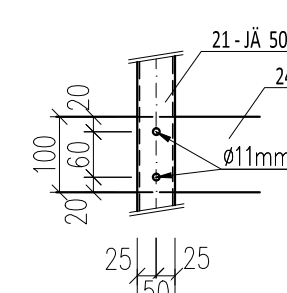

TYPICKÝ ŘEZ
M 1:10

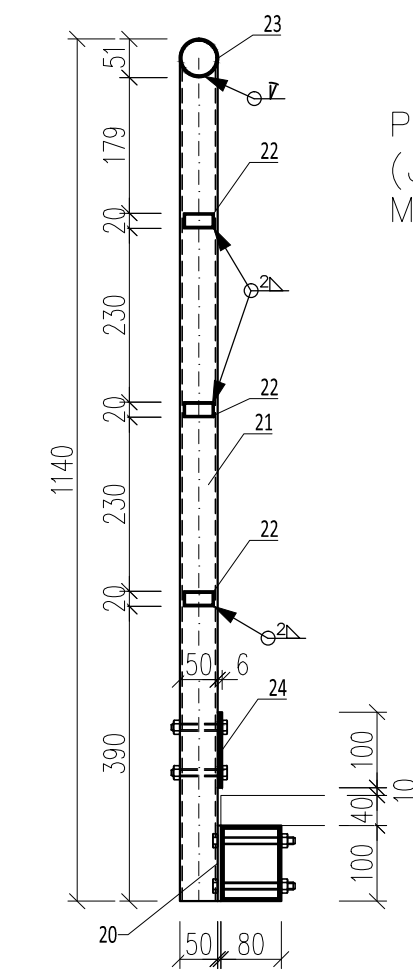

ZÁBRADLI																Hmot.	
TYP	OZN	Plocha	ks	Hmot.	OZN	Délka	Hmot.	OZN	Délka	Hmot.	OZN	Délka	Hmot.	OZN	Délka	Hmot.	Hmot. celkem
Z1	20	0,013m2	7ks	2,86kg	21	7,63m	34,56kg	22	9,69m	17,44kg	23	3,58m	11,10kg	24	3,58m	16,86kg	82,82kg
Z2		0,013m2	5ks	2,04kg		5,45m	24,69kg		2,415m	4,35kg		2,665m	8,26kg		2,677m	12,61kg	39,34kg
Z3		0,013m2	4ks	1,63kg		4,36m	19,75kg		1,745m	3,14kg		1,945m	6,03kg		1,945m	9,16kg	39,71kg
Z4		0,013m2	7ks	2,86kg		7,63m	34,56kg		3,460m	6,23kg		3,81m	11,81		3,81m	17,94kg	73,40kg
Z5		0,013m2	3ks	1,22kg		3,27m	14,81kg		2,050m	3,69kg		2,200m	6,82kg		2,212m	10,42kg	36,96kg
Z6		0,013m2	7ks	2,86kg		7,63m	34,56kg		3,310m	5,96kg		3,660m	11,35kg		3,660m	17,24kg	71,97kg
Z7		0,013m2	3ks	1,22kg		3,27m	14,81kg		1,250m	2,25kg		1,400m	4,34kg		1,400m	6,59kg	29,21kg
Z8		0,013m2	2ks	0,82kg		2,18m	9,88kg		1,216m	2,19kg		1,316m	4,08kg		1,316m	6,20kg	23,17kg
Z9		0,013m2	4ks	1,63kg		4,36m	19,75kg		2,480m	4,46kg		2,680m	8,31kg		2,692m	12,68kg	46,83kg
Z10		0,013m2	2ks	0,82kg		2,18m	9,88kg		1,035m	1,86kg		1,135m	3,52kg		1,135m	5,35kg	21,43kg
Z11		0,013m2	5ks	2,04kg		5,45m	24,69kg		2,835m	5,10kg		3,085m	9,56kg		3,097m	14,59kg	55,98kg
Z12		0,013m2	3ks	1,22kg		3,27m	14,81kg		1,579m	2,84kg		1,729m	5,36kg		1,741m	8,20kg	32,43kg
Z13		0,013m2	2ks	0,82kg		2,18m	9,88kg		1,460m	2,63kg		1,560m	4,84kg		1,410m	6,64kg	24,81kg
Z14		0,013m2	2ks	0,82kg		2,18m	9,88kg		0,430m	0,77kg		0,530m	1,64kg		0,530m	2,49kg	15,6kg
Z15		0,013m2	4ks	1,63kg		4,36m	19,75kg		1,730m	3,11kg		1,930m	5,98kg		1,930m	9,09kg	39,56kg
Z16		0,013m2	3ks	1,22kg		3,27m	14,81kg		1,528m	2,75kg		1,678m	5,20kg		1,678m	7,90kg	31,88kg
Z17		0,013m2	6ks	2,45kg		6,54m	29,63kg		3,040m	5,47kg		3,340m	10,35kg		3,340m	15,73kg	63,63kg

OZNAČENÍ:
20—Plech tl. 4mm
21—jäckl 50/3mm
22—jäckl 40/20/2mm
23—TR 51/2,6mm
24—plech tl. 6mm

OCEL S235
SPOJOVACÍ MATERIÁL 8.8

- PŘED VÝROBOU NUTNÉ OVĚŘIT ROZMĚRY NA STAVBĚ
- U SVARŮ UVEDENA JMENOVITÁ TLOUŠŤKA
- ÚKOSY PRO SVARY NEODEČTENY



			ČÍSLO SOUPRAVY:
REVIZE Č.	DATUM	ZMĚNA	

MCO MORAVIA CONSULT Olomouc a.s.
LEGIONÁŘSKÁ 1085/8, 779 00 Olomouc

tel.: +420 585 570 444
ID schránky: kje9md
e-mail: horava@moravia.cz
<http://www.moravia.cz>

OBJEDNATEL Správa železniční dopravní cesty, státní organizace
v zastoupení: SZDC, s.o., Stavební správa východ, Nerudova 1, 772 58 Olomouc

[illegible]